

2011 CEFPI North East Region  
Exhibition of School Planning and  
Architecture

Safari Green School House

Phoenix, Arizona  
Concept  
Elementary School  
Burt Hill, a Stantec Company

# Safari Green School House



# Community Environment

The Safari green school house is a collaborative effort between Cause and Effect Evolutions, Brighten a Life non profit foundation, Burt Hill a Stantec Company, and several other partners who are volunteering their time and services and donating products. The purpose of this collaboration is to provide a 21<sup>st</sup> century sustainable educational facility as a gift and resource to a well deserving community. Several schools submitted an application for this gift and after an interview process Roadrunner Elementary School was selected.

The project is intended to provide the school and the community with a multi use educational facility that will include: A community resource center, library, teaching kitchen, STEM classroom, fitness, wellness classroom as well as outdoor educational gardens and fitness spaces.

The project team includes Hensel Phelps Construction who will volunteer their time to construct the project. This effort will also include opportunity for volunteer participation so that community members can have hands on experience of investing in their future



## Learning Environment

The Green School House is physically separated from the existing Roadrunner Elementary School facility. Students will experience a safari as they leave their windowless factory model school through the educational gardens and transition into an educational environment that is geared toward 21<sup>st</sup> century instruction. Collaborative learning is encouraged through provision of seating arrangements and spaces meant to support different groupings and learning styles. Transparency is provided between indoor and outdoor learning spaces to create an energetic synergy and further encourage collaboration.

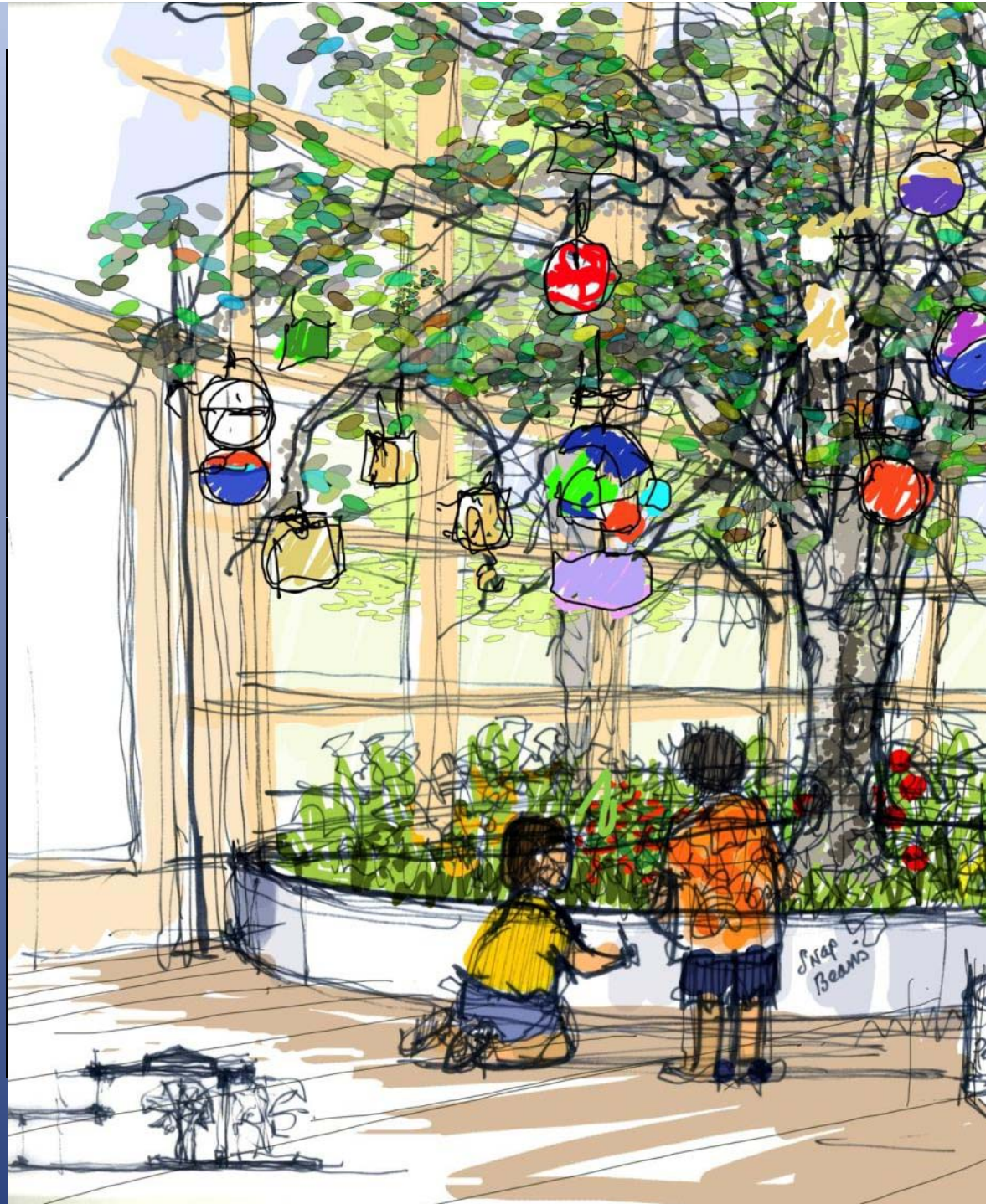

## Physical Environment

The facility is designed to celebrate the natural desert environment. Sustainability and a connection to nature are infused in the design in an effort to provide a learning opportunity through experiencing the building. Community members enter through an educational garden that will include native vegetation. Large windows are located on the North elevation to allow diffused natural light to penetrate the learning environment. Storm water will be conveyed through a free flowing gutter into a cistern which overflows to a xeriscaped basin. Energy generation will be provided through photovoltaic panels and an energy efficient heating and cooling system will be incorporated. A digital dashboard will be installed so that students can monitor energy generation and usage.

The building will be submitted to USGBC with the goal of LEED platinum.



## Planning Process

An education plan for the Safari Green Schoolhouse was developed by The National Center for the Learning Environment (NCLE). This document was developed through a collaborative effort between NCLE, community members, school administrators, staff, Burt Hill a Stantec Company and Cause and Effect Evolutions. The planning document outlined the educational requirements and the community expectations for the project. It also detailed the spaces that were required and that would be funded by the program.

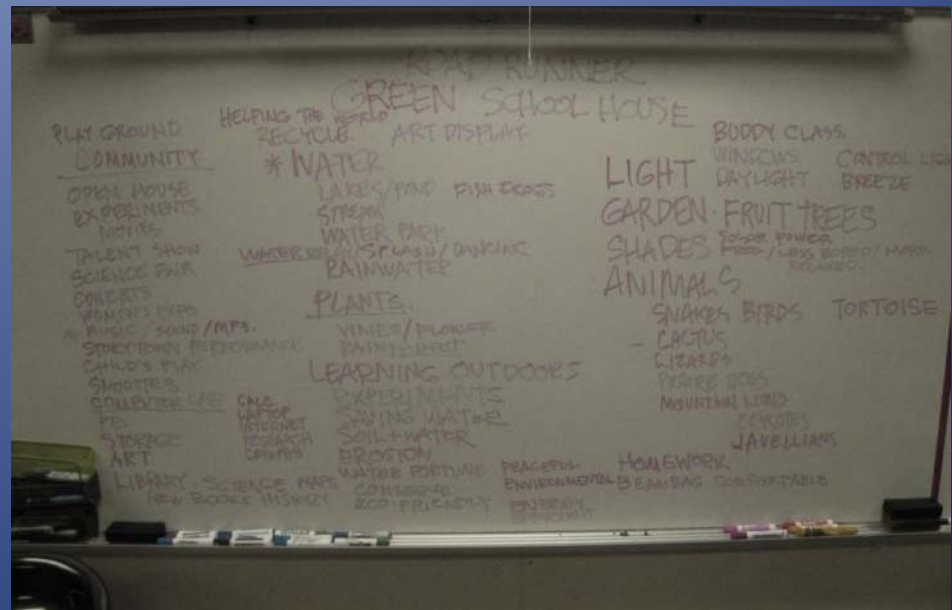

## Planning Process

Burt Hill a Stantec Company facilitated a design charette with the students, faculty, and staff to develop a concept specific to the needs of the Roadrunner community. Students were given the assignment to research native vegetation to attract butterflies and other animals. The faculty planned a field trip to the Desert Botanical Garden in Phoenix to complete the research for this portion of the project.

All participants in the planning effort will be encouraged to volunteer their time during the project construction so that they can have a hands on experience in bringing this project to fruition.





**FLOOR PLAN**

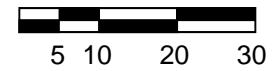

# Exhibition of School Planning and Architecture 2010 Project Data

<b>Submitting Firm :</b>	<b>Burt Hill, a Stantec Company</b>
Project Role	Architecture, Landscape
Project Contact	Rob Pillar
Title	Principal
Address	101 E. Diamond Street, 400 Morgan Center
City, State or Province, Country	Butler, PA
Phone	724-477-1212

<b>Joint Partner Firm:</b>	<b>Cause and Effect Evolutions</b>
Project Role	Program Administrator
Project Contact	Marshall Zotara
Title	Managing Partner
Address	2111 Palomar Airport road
City, State or Province, Country	Carlsbad California
Phone	760-431-5400

<b>Other Firm:</b>	<b>Washington Elementary School District</b>
Project Role	Gift recipient
Project Contact	Sue Pierce
Title	Director of Facility Planning
Address	4650 West Sweetwater
City, State or Province, Country	Glendale, AZ 85304
Phone	602-347-2847

<b>Construction Firm:</b>	<b>Hensel Phelps Construction</b>
Project Role	Contractor
Project Contact	Alex Bertolini
Title	Project Manager
Address	502 S. 24th Street
City, State or Province, Country	Phoenix, AZ
Phone	480-289-3780

# Exhibition of School Planning and Architecture

## 2010 Project Details

<b>Project Name</b>	Safari Green School House
<b>City</b>	Phoenix
<b>State</b>	Arizona
<b>District Name</b>	Washington Elementary School District
<b>Supt/President</b>	
<b>Occupancy Date</b>	Winter 2012
<b>Grades Housed</b>	K-5
<b>Capacity(Students)</b>	Roadrunner Elementary School serves 750 students. The Safari Green School house will provide and additional 3 teaching stations.
<b>Site Size (acres)</b>	
<b>Gross Area (sq. ft.)</b>	6,000
<b>Per Occupant(pupil)</b>	N/A
<b>gross/net please indicate</b>	
<b>Design and Build?</b>	No
<b>If yes, Total Cost:</b>	
<b>Includes:</b>	
<b>If no,</b>	
<b>Site Development:</b>	No Cost No Cost
<b>Building Construction:</b>	No Cost
<b>Fixed Equipment:</b>	No Cost
<b>Other:</b>	No Cost
<b>Total:</b>	